

WOODDALE MAGAZINE

WINTER/SPRING 2016



03

**LIVING
REGRET FREE**

05

**DON'T LIVE
LIFE ALONE**

15

**ESCAPING
THE GRAVE**

17

**MAKING
A MINISTRY**

Welcome to the

Wooddale Magazine

Welcome to Wooddale Church!
Crystal Alvarez, Communications Lead

WOODDALE CHURCH IS WHERE GENERATIONS GATHER.

At Wooddale, we believe that everyone is on a spiritual journey and we want to be there to help you find your next step. In this edition of the Wooddale Magazine, you will find stories and opportunities that inspire and challenge you to **Know God** on a deeper level, **Grow** in Him and be involved in a culture where we **Serve** our church, our neighbors and those in need, globally.

VISION '22

Exciting things are happening as we work toward our vision "To impart the hope of the Gospel to 700,000 people here, near and far..." Celebrate with us as we launch our 3rd multi-site, plant hundreds of churches in Asia and prepare our Eden Prairie Campus for friends and families to **Connect**.

UPCOMING SERMON SERIES

For over a year, the entire pastoral staff has been planning for an extraordinary sermon series in January. Our entire church will have an opportunity to get involved—from our young children through Senior Adults. The *One Month to Live* series will encourage us to live life without regrets and give everyone an opportunity to find a place in LifeGroups. Having a LifeGroup of friends makes sense when life is great but also when challenges come our way. Don't live life with regrets and don't live life alone!

In February we will be personally stretched as we seek to define what we are FOR. Churches are so often known for what they are against. Let's show everyone in our community what we are FOR! **Engage** by inviting your friends.

On Easter, we are preparing a place for you, your family, neighbors and friends. Come and experience Jesus' tomb in a powerful way. We don't want you to miss out! Plan to attend and invite everyone you know!

2016 is going to be an exceptional year! We have plans for every generation and we can't wait to watch how God works in and through us as it all unfolds.



MISSION STATEMENT

To honor God by making more disciples for Jesus Christ.

VISION STATEMENT

To impart the hope of the Gospel to 700,000 people here, near and far over the next 7 years, and to provide a clear pathway toward spiritual maturity.

SPIRITUAL PATHWAY

GET TO KNOW GOD

There are people who are searching for meaning, hope and a relationship with God through Jesus Christ. Do you know someone who is searching?

CONNECT

People want a connection with God and to others who already know God. We want to be the most authentic and loving body of believers in the Twin Cities.

GROW

We grow by knowing and doing. Growing happens for all ages on the weekend and during the week by hearing and applying the practical teaching of God's word.

SERVE

Opportunities to serve abound. Serving can be done as a volunteer on a Wooddale campus, in your neighborhood by showing God's love or serving in a remote village through Wooddale Worldwide.

ENGAGE

We want to always be thinking of those who do not know Jesus yet. We can PRAY, SERVE and look for the opportunity when He opens the door for us to SHARE how Jesus has changed our lives!

Table of Contents

-
- 3** *One Month to Live*
Live a no-regrets life!

 - 5** *LifeGroups*
Don't live life alone

 - 7** *Vision '22 "Here"*
Construction is coming soon!

 - 9** *Vision '22 "Near"*
Where is Multi-site 3?

 - 11** *Vision '22 "Far"*
A story of challenge and rescue

 - 13** *Get To Know Edina*
An up close interview with campus staff

 - 15** *Easter*
Escaping the grave

 - 17** *Celebrate Recovery*
The making of a ministry — Behind the scenes

 - 19** *Children*

 - 21** *5/6 Grade*

 - 22** *Jr. High*

 - 23** *Sr. High*

 - 25** *Classes, Studies and Groups*
Listed by day of week

 - 28** *Events*
Listed by month



One Month to Live

She looked different, talked different and even smelled different. Nothing about “the new girl” was like anyone else in her new 6th grade class. Rather than welcoming her, most of the 6th graders decided to be mean to her. If she sat down at a lunch table, everyone would get up and move. When she walked into a room, they whispered about her. I was in that same 6th grade class and in my heart knew I should stand up for her. Just a year earlier, I was “the new girl.” I was the one who was different and received the same kind of treatment. I understood her pain. Although I didn’t take part in the meanness, I also didn’t stand up for her. All these years later, I regret not standing up to the mean kids to make a difference in “the new girl’s” life.

Heather Flies, Jr. High Pastor

Do you have regrets, like Pastor Heather, something you said or did that you would change if you were given the chance? Have you dreamed about writing that book or climbing that mountain, but never have made time for it? Did you say yes when you should have said no? Did you

leave when you should have stayed? We all have them, those regrettable moments that define a part of us we wish was not part of our past.

What would you do differently if you found out you only had one month left to live? Kerry and Chris Shook, authors of the book *One Month to Live, Thirty Days to a No-Regrets Life*, challenge us to make the most of life, to commit with God’s strength to live thirty days as if they were our last. This book shows us how to move from where we are toward a better, more fulfilling place.

We all want to live without regrets and *One Month to Live* gives us the encouragement to start doing that today.

January 9/10: Living the Dash

Have you seen the grave markers with the birth date, then a dash, and then the date of death? From the moment you are born to the moment you die, you are living the dash. Living life with a group of people who will walk with you through it all brings purpose and fulfillment to life. Commit to be in or lead a LifeGroup and “Live the Dash” with people who matter to you.

John 10:10 (NIV) The thief comes only to steal and kill and destroy; I have come that they may have life, and have it to the full.

Our entire church will have an opportunity to get involved—from our young children through Senior Adults. Don’t miss out on this journey toward living a no-regrets life. *One Month to Live* books are available for purchase in Gather Café & Exchange for \$13.95 (includes tax)—why not buy one for a friend and invite them to this series?

Pastor Dale will be unpacking the 5-week *One Month to Live* series during our weekend services. We hope you not only accept the “Thirty days to a no-regrets life” challenge in the book, but also consider Living the Dash by getting involved with a LifeGroup. There are special 5-week LifeGroup opportunities specifically for this series.

Go to wooddale.org/lifegroups to find out more about joining a group.

January 16/17: Live Passionately

This is our one and only life, and it is time to start to “Live Passionately” through God’s Son. Don’t wait to live!

1 John 5:11-12 (NLT) And this is what God has testified: He has given us eternal life, and this life is in his Son. Whoever has the Son has life; whoever does not have God’s Son does not have life.

January 23/24: Love Completely

Love is not love until you give it away. That is what Jesus did—even when He was betrayed. What would be required of you to “Love Completely?”

Matthew 22:37-39 (NLT) Jesus replied, “You must love the Lord your God with all your heart, all your soul, and all of your mind.” This is the first and greatest commandment. A second is equally important: “Love your neighbor as yourself.”

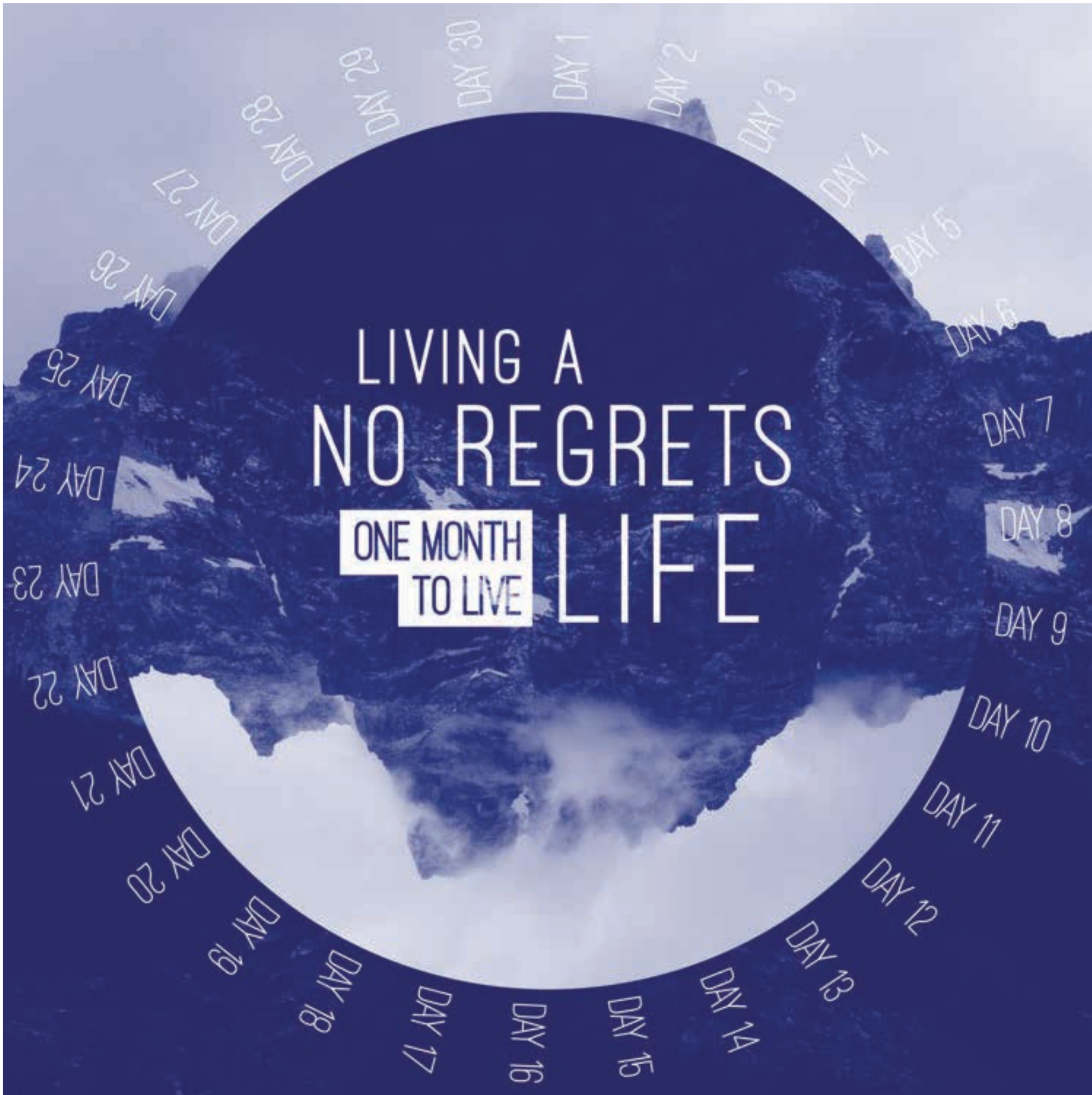

January 30/31: Learn Humbly

If you only had thirty days left to live, what would happen to your pride, boldness and dependence on God and others? Why not start to depend more on God now?

Philippians 2:8 (NLT) He humbled himself in obedience to God and died a criminal's death on a cross.

February 6/7: Leave Boldly

Have you given thought to the legacy you will leave behind? Will you be known for your character, convictions and involvement in your community? Make each moment you live count!

Ecclesiastes 3:11 (NIV) He has made everything beautiful in its time. He has also set eternity in the human heart; no one can fathom what God has done from beginning to end.

LifeGroups



Pastor John Hann, LifeGroups

Have you ever looked at someone's Facebook™ page, only to discover they don't have much of anything posted? You think, "Well, that was a waste of time. This doesn't tell me anything about this person." But really, what does someone's online profile tell you about them, anyway?

Just this fall 2015, social media star Essena O'Neill—a 19-year-old Australian girl with well over 600,000 followers—shocked the social media world by denouncing her online fame. By the age of 15, Essena had achieved what many would call the good life. She had it all. She had health, money, good looks, and hundreds of thousands of adoring fans. All because of the pictures she took and posted for the world to see.

Don't Live Life Alone
Join a LifeGroup

What more could we possibly want in life?

For a while, Essena wanted nothing more. All she had to do was look beautiful and get people to "favorite" her photos on Instagram™. As time went by, things began to wear down. Essena developed an addiction to posting her photos. She couldn't be happy except when she was plastering pictures of herself on social media. It would take her hours and hundreds of takes to get a shot that she felt good about posting. A deep feeling of emptiness about life eventually took hold. No matter how stunning her photos were, they couldn't give her fulfillment. At last, she realized her whole identity was a fabrication.

She wanted something more in life.

Essena dramatically and publicly disposed of the identity that she had taken years to carefully—painstakingly—craft. She wiped out the vast majority of her photos, but saved a few so that she could edit the captions and tell the truth behind her photos. In one of the captions Essena discloses, “The only thing that made me feel good that day was this photo. How deeply depressing! Having a toned body is not all we as human beings are capable of.” So, what is it Essena truly searches for?

What do we deeply need in life?

In the wake of Essena’s transformation, many have claimed it to be a publicity stunt. Maybe so! Regardless of what she’s using this new fame for, her actions still reveal not just what we want in life, but something we deeply need: community, care, challenge, and commitment from people who truly know who we are—and who see our true identity.

Indeed, we live in an unprecedented era of isolation. Never before has it been so easy to go through life, merely cycling through transactional interactions that rarely develop into the transformational relationships for which God designed us. The trouble, is if we spend all our time like Essena, intentionally controlling how others see us, then even if we do experience acceptance, deep down we know they are just accepting us in a mask. That is why in the midst of crowds and social media we can feel so isolated and alone. People are not connecting with our true identity.

What can we do?

Here at Wooddale, we offer a way to experience what so many crave and need. LifeGroups offer community, care, challenge, and commitment with a group of 8-16 other people. You don't have to live life alone; start living life fully by joining a LifeGroup.



Gustafson LifeGroup | Camping With God Series

FAQs:

Q: How do I find a LifeGroup to join?

A: Finding a group has never been easier! Simply visit Wooddale.org/LifeGroups online, click Find-a-LifeGroup, then search our groups and contact a group that looks best for you. You can also stop by one of our LifeGroup walls located on all campuses.

Q: What if I already have community, care, challenge, and commitment from people who know who I truly am? Should I join a LifeGroup?

A: No. Start and lead a LifeGroup instead! Imagine all the others who you can share your blessings with. As a LifeGroup leader, you can help others experience rich relationships like you have! There is no prior experience necessary, as we provide an atmosphere that equips our leaders for sustainable success for those willing to make the commitment to lead a group. If you are interested in being a LifeGroup leader, please let us know at Wooddale.org/LifeGroups, or at one of our LifeGroup walls.

Q: What if I don't want to join a group? Isn't there another way? Aren't relationships better when they happen organically?

A: Please, say goodbye to the idea of organic friendships. Somewhere along the line, someone started saying that meaningful relationships only happen “organically,” or naturally. That idea is simply false. The truth is, good happens when sought after intentionally. If we want meaningful relationships, we need to be intentional about finding them. Be intentional: Join a LifeGroup.

Wooddale currently has over 100 LifeGroups!

“Many of my closest and trusted relationships have come from living life in Groups with others.”

Hebrews 10:24-25 (NIV)

²⁴ And let us consider how we may spur one another on toward love and good deeds, ²⁵ not giving up meeting together, as some are in the habit of doing, but encouraging one another—and all the more as you see the Day approaching.

Vision '22 | Here



Phase Key

- 
PHASE 1A March through May 2016
- 
PHASE 1B March through August 2016
- 
PHASE 2 June through August 2016

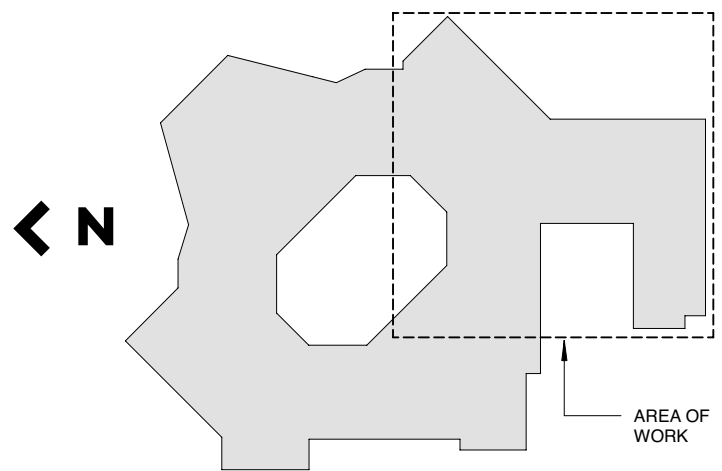

Key Plan - Main Level

Children

We are excited for the “Here” portion on the Eden Prairie campus. We have the opportunity through Vision ’22 to create environments that kids will love and will want to come back to. These new, safe, secure and engaging environments (along with the Orange curriculum) will be the perfect combination to keep families excited about learning more, hearing truths and being involved in a supportive and fun community.

Students

It may surprise you that our Jr. High and Sr. High ministries have never had designated spaces of their own. Through the Vision ’22 campaign, that will change. We are praying for these spaces and look forward to what God will do.

Senior High Impact

Our Sr. High Ministry is excited to call the Great Room home for their Wednesday program, Impact. It is a big deal to have a designated entrance, upgraded audio visual and plenty of room to worship and be challenged to grow in their faith.

The Great Room will be available all other days of the week for adult classroom space, meeting space, and large events when needed.

Junior High Ministry

Revamping the Gym will give our Jr. High students a place to be highly active, worship freely and connect with other students and leaders in a space they can call their own. Pastor Heather has worked with the Ministry Project Team and architects from MSR to find solutions for portable furniture, staging with concealed storage, upgraded AV and an inviting entrance to welcome our students and first-time student guests.

Café

As part of our Vision ’22 campaign, Gather Café & Exchange is being designed to become a destination “Where Generations Gather.” We are excited to open our doors to the community and welcome people to Wooddale with a great cup of coffee, fantastic food selections, awesome art exhibits, sermon series resources and products that are sold with a purpose.

A team of staff and volunteers is working together with the architects and designers at MSR to make Gather Café & Exchange a great place to be. Construction will begin March 1, with completion of Gather expected in June.

If you are interested in being part of something great, consider serving with this team of coffee enthusiasts who also have a missional heart. Email jose.alvarez@wooddale.org to find out more.

Programming will continue during remodeling

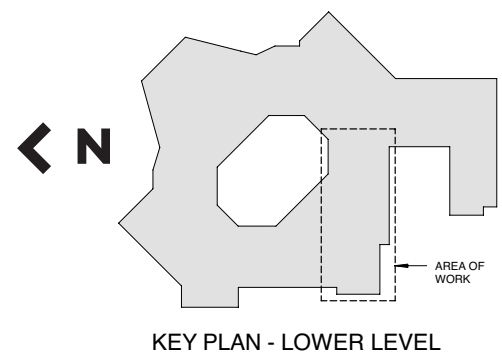
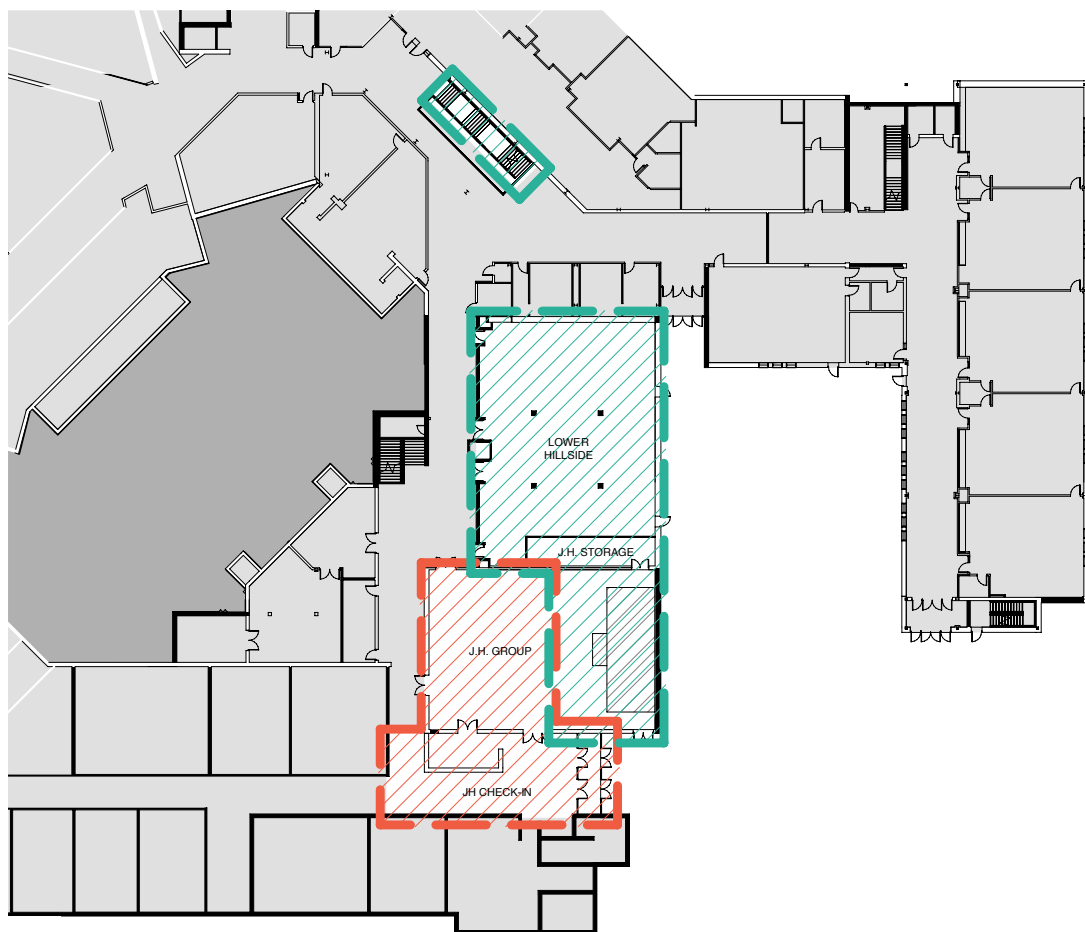

Vision '22 | Near

Loring Park Campus @ Music Box Theater | Multi-Site 3

In the picture to the right are the ancient ruins of what was once known as Caesarea Philippi in northern Israel. This land was beautiful with massive rocks and deep caves, and was a water source for the Jordan River that flowed in Israel. While the river was familiar to the disciples, there were so many differences between the disciples and Caesarea Philippi. The abundant water supply and hills attracted many Gentiles to the area, and therefore there were different cultures and different gods. Caesarea Philippi stood in stark contrast to the disciple's worldview. It was a busy place, and it was in this setting Jesus asked His disciples, "Who do you say that I am?"

¹⁶ Simon Peter answered, "You are the Messiah, the Son of the living God." ¹⁷ Jesus replied, "Blessed are you, Simon son of Jonah, for this was not revealed to you by flesh and blood, but by my Father in heaven." ¹⁸ And I tell you that you are Peter, and on this rock I will build my church, and the gates of Hades will not overcome it.

Matthew 16:13-18 (NIV)

Why did Jesus choose this setting, so different from His home of Galilee, to ask for a confession of belief and then to make such a profound declaration about the future of His church? What Jesus was telling His followers then and now is:

"I want my church to make an impact in the most diverse places in the world! Go where they don't know me. Go!"

When you read the book of Acts, that's what the first disciples did. They went to epicenters of commerce and cultures like Ephesus, Rome and Corinth, and brought the hope of the Gospel and the life-changing presence of Christ.

God has opened up a huge opportunity for us to continue the mission of Christ right here in Minneapolis. After much prayer, consultation, and deliberation, Wooddale Church is going to start its 3rd campus at the famed Music Box Theatre in downtown Minneapolis. The journey has been truly miraculous and we can hardly wait to share the story with you in January!



Caesarea Philippi

What we can tell you is that urban ministry may be different in approach and will stretch us to depend on God. But as servants and witnesses for Jesus Christ, we will be sharing the same truth and the same hope that is good news for all people! We have prayed as individuals, as a Vision '22 "Near" team, and as a congregation. We have also done our research, met with and prayed with well-known urban evangelical churches, and have sought counsel from urban ministries. God has answered those prayers and we are confident that He is calling us to join other Christ-centered churches in reaching the heart of the Twin Cities - that we love. This will be our community for our 3rd site. This is our Caesarea Philippi, a place of exchanging cultures where Jesus wants us to make Him known.

"This area of Minneapolis is growing, changing and diversifying and is a key focus of development for the city."





Loring Park Campus @ Music Box Theatre

See page 28 for Loring Park Campus vision meetings in January and February of 2016

3rd Campus Launch Timeline

DECEMBER

JANUARY

FEBRUARY

MARCH

APRIL



Facility secured

Announce 3rd site; Call to prayer as a church

Vision meetings for information about 3rd site and ways to join the core team

Core team building & serving around the site

Commission service for core team

Pre-launch services at new site

Services at new site

27% of people within a 2 mile radius of the Music Box Location decreased their faith involvement in the past 10 years; 35% are not involved with faith at all — 45,000 people!



FreeseT | Far

The House that Jack Built is a classic nursery rhyme that causes anticipation with each new character that is added. Somehow bringing a cat, cow, maiden and so many more characters together creates one story. In this rendition, *The Place that God Built*, there is something wonderful about how people half-way around the world from each other speak into this amazing story of challenge and rescue.

The Place that God Built

This is the place that God built.

These are the women

That work in the place that God built.

This is the couple

That care for the women

That work in the place that God built.

This is our church where worship is held

That supports the couple

That care for the women

That work in the place that God built.

These are the students who in comfort dwelled

That stepped up for our church where worship is held

That supports the couple

That care for the women

That work in the place that God built.

This is our Sr. High Pastor feeling compelled

That challenged our students who in comfort dwelled

That stepped up for our church where worship is held

That supports the couple

That cares for the women

That work in the place that God built.

This is a young girl, her identity withheld

That left our Sr. High Pastor feeling compelled

That challenged our students who in comfort dwelled

That stepped up for our church where worship is held

That supports the couple

That cares for the women

That work in the place that God built.

This is an opportunity that is unparalleled

That rescued a young girl, her identity withheld

That left our Sr. High Pastor feeling compelled

That challenged our students who in comfort dwelled

That stepped up for our church where worship is held

That supports the couple

That cares for the women

That find JESUS in the place that God built.

The Place



Fabric being prepared for FreeseT products

The Women

Many girls are trafficked from Bangladesh, Nepal and rural India. For many women, poverty has left them without options.

Ashoka's* story

I make bags, but I'm not very good at making the finished bag. I sew the sides of bags and I also supervise tea breaks.

Occasionally I go out visiting brothels. I try to explain to girls that standing in the line is not the only option - they can get regular wages.

My life is good, now it is very good. Sometimes I remember I was in the line, but now I'm not and I like that. I come to work with my head held high - with no shame. I've given up the line, I have freedom and peace.

I want to give God thanks. Jesus has taken me far from my old life. God has given me good things - health, peace, a good husband, good family. There's no more fighting or arguments. My husband doesn't drink anymore.

*Names changed

The Couple

In 1999, Kerry and Annie Hilton left New Zealand with their four children and moved to Kolkata, India to work and live amongst the poor. They discovered they had moved into the largest red light area in the city, Sonagachi, and is even considered one of the largest in Asia. Their new neighbors were thousands of women forced into prostitution by trafficking and poverty.

To make a difference that would bring real freedom for these women, the Hiltons began to understand there needed to be a business alternative employing women to help them sustain a new lifestyle.

Kerry and Annie are thankful that “the Wooddale family has encouraged, resourced, mentored, given of time and business acumen to help grow Freeset for many years. We feel so privileged to walk this freedom journey together.”

Other ways to Support Freeset

- Give to Wooddale Worldwide
- Purchase Freeset Bags in Gather Café & Exchange
- Consider purchasing bags for a corporate event—email worldwide@wooddale.org

As part of the Untamed Series in October, a live artist painted while communion was being served. It was a very moving and worshipful experience. Pastor Dale was inspired to have the paintings auctioned in an anonymous, silent auction with all proceeds going to Freeset and with an additional gift from Wooddale Worldwide, \$10,000 was given to Freeset.



Deneena Hughes - Live artist during communion



Mark Warder, Sr. High Pastor



Kerry and Annie Hilton

The Students

In November, our Sr. High students started talking, thinking, praying and asking their friends and classmates at school to help them raise money to support Freedom Opportunity 2016, a Freeset program in India that provides alternatives for girls from entering the sex trade. They set a goal to raise \$10,000 which would allow 10 girls to experience this 6-month program.

Our students raised an astonishing \$13,861!
The “next generation” is the church of today!

What does this mean?

More than 10 girls will now have the opportunity to:

- learn how to read and write
- learn a trade and help their families
- hear about Jesus and His love for them
- have the skills and training to escape the sex trade

These students and leaders have pressed into their faith and embodied these verses:

JAMES 2:14-17 (NIV)

¹⁴ What good is it, my brothers and sisters, if someone claims to have faith but has no deeds? Can such faith save them? ¹⁵ Suppose a brother or a sister is without clothes and daily food. ¹⁶ If one of you says to them, “Go in peace; keep warm and well fed,” but does nothing about their physical needs, what good is it? ¹⁷ In the same way, faith by itself, if it is not accompanied by action, is dead.

Edina Team Interview



Edina Campus

In 2008, the Edina campus (formerly Colony Park Church) was given to Wooddale Church and has served as a second campus. In June 2014, we intentionally created programs to reach the Edina Community, and Kyle Robinson was called as the campus pastor. The staff includes Kyle Robinson as the Campus Pastor, Molly Ericson as the Director of Children's Ministry, Lynn Richter as the Campus Coordinator, and Justin Lansdowne as the Worship Director. There has been 30% growth on the Edina campus this past year. Let's ask a few questions to find out what is happening at our Edina campus!

What was your vocation before working at Wooddale Church? What caused you to decide to switch to ministry as a vocation?

MOLLY: I was teaching at a public school and have always believed that my ministry focus should be wherever God places me. After many conversations with Kyle and my closest friends, I took the opportunity to be the Director of Children's Ministry on Wooddale's Edina campus. I have enjoyed watching our program grow and love working with volunteers who have a heart for helping children know God and experience His love.

I'm excited to share that God has once again set a new path before me. I'm going to pursue a ministry opportunity to work with educators in India this spring. My time here at Edina has allowed me to be part of a great team of staff and to get to know amazing volunteers and children! I will be forever grateful for all that I've learned and the relationships that have developed. It is a bittersweet time for me. Leaving something you care deeply about is hard, but I have peace about the journey ahead. I will be working with Kyle and the staff to help with a healthy transition!

KYLE: I, too, came from industry and enjoyed my job in management consulting. I sincerely enjoyed the relationships, challenges, work, and leadership opportunities. I am also finishing my doctorate at Creighton in Organizational Leadership, so I had a full plate, and still do.

However, when God called – and it was a clear calling for me – I listened and discovered God had another plan if I would trust Him. After ten years attending Wooddale church, He called me to the Campus Pastor position which means my responsibility is to support, disciple, serve, shepherd, and encourage those who are in our congregation.

LYNN: I was a member of the school board, a teacher, a coach and pregnant with our fourth child. Andy and I decided that in the midst of all this busyness, I needed to “be still for a year.” After that year, I felt I had been a consumer in the church long enough. I started volunteering with the Connections team on the Eden Prairie campus, but we were soon swooned over to the Edina campus. After a few months volunteering, I became the Campus Coordinator which means I help connect people with opportunities here at Edina and coordinate the administrative details of our campus.

JUSTIN: I grew up on the mission field with my parents, served in the military, attended seminary, and most recently served as a worship leader at another church community. Earlier this year, I sensed God calling me to a new ministry and when Kyle shared the vision of Wooddale, I felt God saying, “This is your next step.” Amidst this new journey with Wooddale, and with Christie (my wife) and I expecting our second little one, I'm also training to be an Army Chaplain. Looking back, I realize that wherever we are in the moment – as followers of Christ – we are called to be missional (on mission).

What goes on every week at the Edina campus?

KYLE: Wooddale Academy is brand new to the Edina campus this year, and meets every weekday. 80% of the families enrolled in the academy do not attend our church, but they bring their children for us to care for them and teach them the truths of the Bible.

Kyle Robinson
Campus Pastor



Lynn Richter
Campus Coordinator



Molly Ericson
Children's Ministry



Justin Lansdowne
Worship Leader



MOLLY: Many of our LifeGroups meet on Wednesday nights so the children can be involved in Woods on Wednesday (W.O.W.). W.O.W. is our midweek children's program for kids up to grade 4. The circle of mismatched chairs we are sitting in right now will be used for a LifeGroup tonight. We use every space possible on this campus.

On Sunday, what is your favorite part of worship?

JUSTIN: When the worship band softens and we can barely be heard but the community is really singing. Everyone worships differently. Some worship with clashing cymbals while others worship quietly to themselves. There is definitely a connection with God when we worship.

The parking lot guys get a lot of positive comments from our first-time guests. How did the parking team get started?

LYNN: My husband, Andy, thought people needed to know that something was going on inside so he went outside and started waving at people. Now we have a team of volunteers at the parking lot with signs, vests and lights so they can be easily seen when they welcome everyone who drives by.

KYLE: Our goal is for our welcome experience to be the most welcoming 7 minutes of a person's week. Everything from the parking lot to the door hosts to those who pour coffee help us welcome people into our church.

JUSTIN: On our first visit to the Edina campus, we were taken aback by such a welcoming community. In the first moments of arrival, we could sense a bit of the ending of Acts 2 (the art of being for one another).

Edina seems to have a strong serving community that is growing. How do you do it?

KYLE: God is good and He has been raising up some wonderful leaders here at Edina. We believe that we are partnering with Him to be on mission. We aren't asking people to volunteer, we are providing them an opportunity to partner with what God is doing here at the Edina campus and invite them into this vision God has given to us.

What is something interesting about the Edina congregation that most people don't know?

KYLE: We still have a group of some of the most faithful and gracious followers of Jesus from Colony Park Church, the church that was in this building before they turned it over to Wooddale. Many of them serve throughout the church and display Christ-like love to our body. It is amazing to see this multi-generational community that is made up of those who are brand new to faith alongside those who have been part of worshiping in this building for over 30 years!

MOLLY: People feel a trust here. It is a place they want to invite others to. They feel comfortable, they experience God and they share that with their friends.

Is there anything else you would like to share with our readers?

KYLE: On my first Christmas Eve as Pastor of the Edina campus, I parked on a side street and as I entered the south side of the building, I noticed a plaque on the building that was put up during the Colony Park days. It says "**More Light Yet to Break.**" I firmly believe that God is moving in this city and I am excited that we can be part of something great.

JUSTIN: Indeed, it's quite brilliant to do life with Wooddale and to lead worship. For when we worship—together through music, prayers, and with our lives—our Creator, it's [long Justin pause...] as if we are practicing what is happening in heaven... Sort of practicing what is to come.

Easter | Escaping the Grave



Easter 2015



One of the sites thought to be Jesus' tomb

Dale Hummel, Sr. Pastor

At a recent charity event in England, magician Anthony Britton—in an attempt to mimic Harry Houdini's failed "Buried Alive" stunt—allowed himself to be buried beneath 6 feet of dirt. Before the buckets of dirt began to shower down on him, he was handcuffed and shackled. But just like Houdini, Britton was unable to dig his way out. He almost died, needing to be extricated from the grave and revived by paramedics.

Lucky to be alive, Britton told the following story of his harrowing experience to National Public Radio's Arun Rath:

I felt myself going unconscious, and I was just trying to focus on, "You've got to do this, you've

got to escape the grave."

But you know, it just got to the point where I'd given it my entire best shot. I had nothing left in my body. ... I could feel myself going under. At that point, everyone knew exactly what to do — and they got to me as quick as they could.

If it's hard to release oneself from being buried alive, imagine how hard it would be for a person to escape the grave if they were already dead? That's exactly what Jesus did!

In Romans 5:17 (NLT), ¹⁷For the sin of this one man, Adam, caused death to rule over many. But even greater is God's wonderful grace and His gift of



Easter Schedule

Ash Wednesday Service

Wednesday, February 10 | 7 p.m.
Eden Prairie Campus

Palm Sunday Services

Sunday, March 20 | Normal service times
All campuses

Maundy Thursday

Thursday, March 24 | 7 p.m.
Eden Prairie Campus

Easter Weekend Services

Saturday, March 26 | 5 p.m.
Eden Prairie Campus

Sunday, March 27 |

- ☐ 7:30, 9, 10:30 a.m. and 12 p.m.
Eden Prairie Campus
- ☐ 9 and 10:30 a.m.
Edina Campus

Children's Easter Services

Saturday, March 26 | 5 p.m.
Sunday, March 27 | 9, 10:30 a.m. and 12 p.m.
Eden Prairie Campus

Family Easter Egg Hunt

between services
Edina Campus

Service times to be announced for
the Loring Park Campus @
Music Box Theatre

righteousness, for all who receive it will live in triumph over sin and death through this one man, Jesus Christ.

In John 10:17-18, Jesus said that He had the authority to lay down His life when He wanted to and to take it back up again.

This is why we celebrate Easter! Jesus died on the cross to pay our sin debt and then arose from the grave to offer us eternal life. His resurrection proves that His sacrifice accomplished God's will to forgive us, it also assures us that when we put our faith in Him we too will beat death!

This Easter, come and experience Jesus' tomb in a powerful way at one of our Easter services.



Celebrate Recovery

Pastor Gary Clark, Care Ministry

We are fascinated with how things are made. Entire TV networks are devoted to showing us how everyday items travel through a maze of machinery before they are delivered to our door. Final products and behind-the-scene realities can sometimes cause a disconnect, but there are times when the story behind the “product” can be as exciting as the product itself! We think that is true for the launch of Celebrate Recovery. While Celebrate Recovery officially launched at Wooddale on September 29, 2015, it is the year-long process of prayer, planning and training leading up to the launch that is the real story.

It started with a dream and a challenge in the summer of 2014. With the encouragement of Pastor Dale, I and two others attended a Celebrate Recovery Summit at Saddleback Church in California. While Wooddale has been and continues to be supportive of community groups such as AA, Alanon, and so many more, the dream was to provide a Christ-centered program that would make both a present and eternal difference in the lives of people. Beyond that, we wanted to provide a place where masks could be removed and authentic community could be experienced no matter what issue a person was facing. At the Summit we discovered in Celebrate Recovery:

- A wide open door for anyone with hurts, habits and hang-ups
- A ministry that is outreach oriented, usually attracting at least 50% of its people from outside the church
- A place where people experience safety and transparency in supportive small groups
- A program where serving is a key part of the healing/recovery process
- All of it centered on the words of Jesus Himself



Convinced this was God’s provision and calling, this small Wooddale contingent began to pray and plan. In January of 2015 a class called “Life’s Healing Choices” was offered. Inherently valuable for anyone dealing with hurts, habits or hang-ups, this class would become the “fishing pool” for those who would eventually launch this ministry. Of the 30 participants in the class, 25 committed themselves to being a part of the Celebrate Recovery launch team. They would be the ones who would nurture the fragile seed of this recovery ministry dream into reality. This was no small commitment and required sacrifice.

For some that meant giving up routines and studies that have played a meaningful role in their lives. As one volunteer said, **“I realized I didn’t need another study to help me grow. It is so much fun to give rather than take in all the time.”**

For others it meant committing over the long haul and that was new and challenging for many. Hurts, habits and hang-ups do not take a holiday, so neither does Celebrate Recovery.

For everyone it meant meeting every Monday evening in late spring and summer to be immersed in the Celebrate Recovery DNA, all the while working on their own “personal stuff.” Volunteers openly shared, prayed over and responded to their excitement and doubts about how they were being called to this new ministry. Several from the group went back to Saddleback Church to attend the 2015 Summit. Again, God met them as they worshiped, celebrated, learned and developed skills with over 3000 people from across the country who were also committed to this Christ-centered ministry. The team came back energized and passionate about this ministry to which God had called them.

Through this incredible team God has created a safe and secure environment where people can share and receive God’s healing.

God has formed a rich and diverse team of people who realize that this is a ministry to which they could give their lives. And give they have. Support volunteers serve meals, greet, staff information tables, set up and take down signs. Program volunteers teach, lead worship, emcee meetings, provide media and tech support, and lead small share groups. Each volunteer position is needed and makes a difference in someone’s life.



Celebrate Recovery Volunteer Team

Contrary to what its name implies, Celebrate Recovery is not just about recovery from chemical dependency or other addictive behaviors. It is for anyone with a hurt, habit or hang-up. Such issues as co-dependency, eating disorders, anxiety, anger, pornography, grief and loss, low self-esteem, sadness and relational dysfunction are representative of the kinds of issues that are shared and cared for.

The entry point for Celebrate Recovery is the Tuesday evening large group meeting that includes:

- 5:45 - 6:20** Optional Meal
- 6:30 - 7:30** Worship, teaching, testimony
- 7:40 - 8:45** Issue/gender specific open share groups

Additionally, in-depth step studies, sponsors and accountability partners play a significant role in the recovery/healing process.

The “product” of changed lives through a Christ-centered program is all the more special when you know the maze of prayer and training we went through to launch. God has been putting together this ministry for over a year and it has turned out pretty amazing. It is only the beginning.

If you or someone you know is struggling with a life issue, join us any Tuesday. No registration, no sign up—just show

up and be a part of an amazing journey toward healing. If you are looking for an opportunity to make a difference in the lives of people, consider volunteering. You do not need any special background or history; just a servant heart and availability. For more information Contact Pastor Gary at gary.clark@wooddale.org.

25 people committed themselves to being a part of the Celebrate Recovery launch team. They would be the ones who would nurture the fragile seed of this recovery ministry dream into reality.

Wooddale church also offers care through our Stephen Ministry. For those who want a Stephen minister to walk with you through difficulties, contact pastoral.care@wooddale.org.

Children

Weekends

At Woods Kids, all children are welcome! All campuses offer children's programming during all of our weekend services. Children can expect interactive worship, engaging Bible lessons and fun activities. Morning programming is available for newborns through 4th grade, and evening children's programming is available for children up to age 5. We look forward to seeing you soon!

Special Events

CHILDREN'S MINISTRY FAMILY EXPERIENCE

Our Children's Ministry Family Experience is the place where kids and parents learn together about God's Big Ideas! It's a 45-minute fun, digital, interactive experience. Our goal is to partner with parents! At the Family Experience we launch the main theme and ideas that K-4th graders are learning about in Treehouse all month long. We also provide each family with resources so that parents can help their kids apply at home what they are learning—where it matters most!

CHILDREN'S EASTER SERVICE

Easter weekend gives your children a chance to experience a celebration specifically crafted for them. There will be music, games, prizes and an Easter message that will impact your child at their level. It will also be a massive Easter egg hunt where your kids are guaranteed to walk away with a bunch of candy. Your kids will not want to miss this!

SPECIAL SUNDAY

Kids will get the chance to experience a special themed service unlike anything they have experienced before. It will be interactive with energetic music and some surprises that your family will not want to miss.

1ST GRADE BIBLE PRESENTATION

Here at Wooddale we want every child to have access to God's Word! Every January we give all of our 1st graders their very own Bible. We ask families to sign up on our website for this event so that we can have plenty of Bibles to go around.



Events January – May 2016

JANUARY 10 1st Grade Bible Presentation

- ┌ 11:15 a.m.
- ┌ Eden Prairie Campus
- ┌ 9 and 10:30 a.m.
- ┌ Edina Campus

JANUARY 17 Sledding, Skating and Pizza Family Event

12 - 3 p.m.
Eden Prairie Campus

JANUARY 29 Children's Family Experience

6 p.m.
Eden Prairie Campus

MARCH 4TH Game, Pizza and Movie Night

5:30 p.m.
Edina Campus

MARCH 11 Game, Pizza & Movie Night

5:30 p.m.
Eden Prairie Campus

MARCH 26 Children's Easter Service

5 p.m.
Eden Prairie Campus

MARCH 27 (EASTER) Children's Easter Service

- ┌ 9, 10:30 a.m. and 12 p.m.
- ┌ Eden Prairie Campus
- ┌ 9, 10:30 a.m.
- ┌ Edina Campus

APRIL 2/3 Special Sunday

- ┌ 8:30, 9:45 and 11 a.m.
- ┌ Eden Prairie Campus
- ┌ 9 and 10:30 a.m.
- ┌ Edina Campus

MAY 18 W.O.W.'s End of the Year Celebration

6:30-8 p.m.
Eden Prairie and
Edina Campuses

MAY 29 4th Grade Move Up to 5th & 6th grade students

9:45 a.m.
Eden Prairie Campus

2016 Parent Child Orientations: 1/17, 4/24, 7/31, 10/30

Eden Prairie Campus

2016 Parent Child Dedications:

- ┌ 1/24, 5/1, 8/7, 11/6
- ┌ Eden Prairie Campus
- ┌ 1/31
- ┌ Edina Campus



W.O.W. (Woods on Wednesday)

W.O.W. is designed with kids in mind! Children experience safe, age-appropriate environments on both campuses where the Bible is taught in a creative way. At The Woods, we believe the Bible should never be boring, worship can

be exciting, and leaders always care! Check out the W.O.W. calendar and see what each week offers. As with all programming at The Woods, our volunteers are background-checked and trained to provide a quality experience for your child. Invite your friends to join the fun at a place where kids meet Jesus on their own level.

DECEMBER	JANUARY	FEBRUARY	MARCH	APRIL	MAY
MAGIC TRICK NIGHT DON'T BELIEVE LIES 2 	DARTS NIGHT DON'T FEAR 6	SERVICE PROJECT NIGHT 3	PAJAMA NIGHT WISDOM 2 	BUBBLE GUM NIGHT GOOD THOUGHTS 6	LEADER APPRECIATION NIGHT SERVING HEART 4
MASK NIGHT GOD'S PLANS 9 	W.O.W. Store CONSTRUCTION NIGHT DO MY BEST 13 	Contest HEART NIGHT LOVE GOD 10	SERVICE PROJECT NIGHT 9	BLING BLING NIGHT STORE UP TREASURES 13 	W.O.W. STORE NIGHT REVIEW 11
CHRISTMAS DECORATION NIGHT LIVE FOREVER 16	Contest Begins HANG IN THERE DON'T GIVE UP 20	Contest SLOW-MO NIGHT PATIENCE 17	RABBIT EARS NIGHT LISTEN AND OBEY 16	GUMMY WORM NIGHT SAY NO TO TEMPTATION 20	CLOSING PROGRAM & AWARD CEREMONY 18
W.O.W. BREAK MERRY CHRISTMAS! 23	Contest TAIL NIGHT FORGIVENESS 27 	Contest Prizes APPLAUSE NIGHT PRAISE AND WORSHIP 24	W.O.W. BREAK HAPPY EASTER! 23	SOUNDS OF PRAISE PERFORMANCE (Eden Prairie) WORSHIP NIGHT (Edina) 27	
W.O.W. BREAK HAPPY NEW YEAR 30			SCRATCH & SNIFF STICKER NIGHT GOOD ATTITUDE 30		

5/6 Grade



SUNDAYS

IGNITE ON SUNDAY MORNINGS

9:45-10:45 a.m. | Eden Prairie Campus
10:30 a.m. | Edina Campus

We IGNITE the passion inside our 5th & 6th grade students to live a life centered on Christ and invite others to do the same.

WEDNESDAYS

RECHARGE ON WEDNESDAY NIGHTS

6:30-8 p.m. | Eden Prairie Campus
6:30-7:45 p.m. | Edina Campus

By Wednesday night, we can feel like the week is long. That is why we invite students to RECHARGE! Students' spiritual lives will get a boost as they experience worship through music, biblical teaching, LifeGroup connection and friendly competitions.

New students are joining us every week. Invite your friends!

Schedule

JAN 8

Friday Frenzy

6 - 8 p.m.
\$5

FEB 12 - 14

Snow Camp

Fri 4:30 p.m. - Sun 4 p.m.
RSVP by 2/8
\$110 by 1/21, \$140 by 2/8

FEB 19

Friday Frenzy

6 - 8 p.m.
\$5

MARCH 11

Friday Frenzy

6 - 8 p.m.
\$5

APRIL 15

Friday Frenzy

6 - 8 p.m.
\$5

MAY 6

Friday Frenzy

6 - 8 p.m.
\$5

MAY 14

The Color Games

2 - 4 p.m.
\$10, RSVP by 5/12

MAY 25

6th Grade Celebration

6:30 - 8 p.m.
RSVP by 5/19
\$6 per adult
(free for 6th grader)

All events meet at Eden Prairie Campus

Junior High

Schedule

JAN 15 - 17

Snow Camp

Fri 4 p.m. - Sun 5 p.m.
RSVP by 1/11
\$155 by 12/28
\$170 by 1/11

MARCH 12

Slipper Formal

5 - 10:45 p.m.
RSVP by 3/10
\$25 (dinner included)

APRIL 15-17

Spring Blitz (8th Grade)

Fri 4 p.m. - Sun 5 p.m.
RSVP by 4/7
\$125 by 3/28, \$140 by 4/7

APRIL 20

One Big Party

6:30 - 8:30 p.m.
Redeemer Bible Church
(16205 MN-7, Minnetonka)

MAY 18

9th Grade Celebration

6:30 - 8 p.m.
No RSVP

MAY 20

AUG Graduation

7 - 9 p.m.
RSVP by May 13

All events at Eden Prairie Campus unless noted otherwise



SUNDAYS

SUPERNATURAL

9:45-10:45 a.m. | Eden Prairie Campus
10:30 a.m. | Edina Campus

Are you ready to have fun on Sunday mornings? 7th-9th grade students worship with live music, awesome teaching and have fun doing activities designed to connect students with the Supernatural Creator of the Universe.

WEDNESDAYS

REALITY CHECK

6:30-8 p.m. | Eden Prairie Campus
6:30-7:45 p.m. | Edina Campus

Are you trying to figure out friendships and how to grow in your relationship with God? Let us help keep you in check every week as we get together on Wednesday nights and talk about the tough topics in life. If you are new, let us know you are here!



Senior High

SUNDAYS

SUNDAYS

Students are encouraged to serve at one service and attend one service on weekends. Join us at “The Hub” by Door 1 on the Eden Prairie campus or the Cafe on the Edina campus to connect with other high school students and their families! Over 100 students serve on our campuses every weekend.

CATALYST*

3:30-5:30 p.m.

Catalyst* is a Christian worldview and apologetics class for our 12th grade students. Catalyst* is designed to equip and train our seniors to confidently stand firm in their faith after high school. We meet on select Sundays at the Eden Prairie Campus from 3:30-5:30 p.m. Sign up at wooddale.org/calendar.

WEDNESDAYS

IMPACT

6:30-8:15 p.m.

Impact on Wednesday nights is a time for students to grow in their faith as they worship through music, hear testimonies, learn from relevant biblical teaching and connect in LifeGroups.

PIZZA AND GOD TALK

9-10 p.m.

Pizza and God Talk is a large-group discussion where students can bring their questions about God, faith, culture and the Bible. Jan 13, Feb 10, Mar 16, Apr 27 (at the Eden Prairie Davanni's).

[For more information or to register visit us at wooddale.org](#)

Schedule

JANUARY 6

Impact 2016 Kickoff

6:30 - 8:15 p.m.

JANUARY 10

Chicago & Guatemala Mission Trip Information Meetings

12 - 1 p.m.

JANUARY 20

Mission Trip Applications & Registrations Due

to lauren.miller@wooddale.org

FEBRUARY 26-28

Snow Camp

RSVP by February 22

\$145 by February 4, \$165 by Feb 22

Departure | 4 p.m. (Feb 26)

Arrival | 5 p.m. (Feb 28)

MARCH 9

309

6 - 9 p.m.

Our largest outreach event of the year featuring the Power Team 2.0

APRIL 20

One Big Party

6:30 - 8:30 p.m.

Redeemer Bible Church

(16205 MN-7, Minnetonka)

MAY 15

Senior Baccalaureate Service & Dessert

4 - 5:30 p.m.

Free for graduates

\$5 for family & friends

JUNE 11-18

Chicago Mission Trip (10th graders)

JUNE 12 - 25

Guatemala Mission Trip (11th graders)

JULY 5-15

Israel Vision Trip (12th graders)

All events meet at Eden Prairie Campus unless noted otherwise

Students Serving Beyond our Borders

“Being a part of the service team was especially eye-opening for me because I realized that living out your faith as a Christian isn’t all about preaching the Gospel to others through words. Some of the most powerful testaments of our faith come through our actions. We helped a small family in San Marcos build a new kitchen. Being able to see something be built from nothing was amazing, and the smiles on the family members’ faces

were so fulfilling. Seeing God’s love being acted out and making a difference was life-changing. Being able to serve whole-heartedly and selflessly in Guatemala was an amazing way for me to live out my faith and share God’s amazing love with others.”

– James A.



impact

Recurring Events

Listed alphabetically by day

MONDAY

Alanon

Community Group

Weekly 7 – 9 p.m.
Eden Prairie Campus

Book Club

Women's Social Group

Second Monday 1 – 3 p.m.
Second Monday 7 – 9 p.m.
Free – No Registration
Eden Prairie Campus

Bryant Lake AA

Community Group

Weekly 7 – 9 p.m.
Eden Prairie Campus

Edina Café Open House

Monthly 6 – 8 p.m.
January 5 and April 11
Free – No Registration Required
Edina Campus

TUESDAY

All Church Prayer Time

Prayer Group

Weekly 5:45 – 6:45 p.m.
Eden Prairie Campus

Celebrate Recovery

Wooddale Support Group

Weekly 5:45 – 8:45 p.m.
Eden Prairie Campus

Courageous Voices

Women's Bible Study

Weekly January 19 – March 8
9:30 – 11:15 a.m.
\$15 – Registration Required
Eden Prairie Campus

Daily Reprieve AA

Community Group

Weekly 6 – 8 p.m.
Women Only
Eden Prairie Campus

Edina Café Open House

Monthly February 8
March 1, and May 3
6 – 8 p.m.
Edina Campus

God's Great Reveal

Women's Bible Study

Weekly January 12 – May 3
9:30 – 11:15 a.m.
\$30 – Registration Required
No Class March 22 and 29

For Men Only

Wooddale Support Group

Weekly 6:30 – 8 p.m.
Eden Prairie Campus

IMMT Women

Prayer Group

Weekly 1 – 2:30 p.m.
Eden Prairie Campus

Job Transition

Wooddale Support Group

Weekly 7:15 a.m. – 12 p.m.
Eden Prairie Campus

Moms in Prayer

Prayer Group

Weekly; day and time vary
Eden Prairie Campus

Health & Fitness

Women's Group

Weekly January 5 – March 22
9:30 – 10:30 a.m.
\$50 – Registration Required
Eden Prairie Campus

Mid-Story Times

Women's Bible Study

Weekly April 12 – May 24
9:30 – 11:30 a.m.
\$15 – Registration Required
Eden Prairie Campus

Midweek

Wooddale Bible Study

Weekly Jan 12 – May 3
6:45 – 8:15 p.m.
\$25 – Registration Required
No Class March 22
Eden Prairie Campus

One Thousand Gifts

Women's Bible Study

Weekly April 12 – May 10
6:45 – 8:45 p.m.
\$20 – Registration Required
Eden Prairie Campus

Real Housewives of Israel

Women's Bible Study

Weekly January 12 – March 15
6:45 – 8:45 p.m.
\$15 – Registration Required
Eden Prairie Campus

WEDNESDAY

2 Timothy Precept

Women's Bible Study

Weekly January 20 – May 4
9:30 – 11:30 a.m.
\$29 – Registration Required
No Class March 23
Eden Prairie Campus

5th & 6th Grade RECHARGE Student Class

Weekly January 6 – May 18
6:30 – 8 p.m.
Eden Prairie Campus
6:30 – 7:45 p.m.
Edina Campus
Free – No Registration
No class March 23

Caregiver Tools

Wooddale Class

Weekly January 20 – February 24
10 a.m. – 12 p.m.
Eden Prairie Campus

Discerning Voice of God

Women's Bible Study

Weekly January 13 – February 24
9:30 – 11:30 a.m.
\$20 – Registration Required
Eden Prairie Campus

Getting To Know Wooddale

Wooddale Class

Weekly January 27 – February 3
6:30 – 8 p.m.
Free – Registration Requested
Eden Prairie Campus

Jesus the One and Only

Women's Bible Study

Weekly January 13 – March 23
9:30 – 11:30 a.m.
\$25 – Registration Required
Eden Prairie Campus

Junior High Reality Check

Student Class

Weekly January 6 – May 18
6:30 – 8 p.m.
Eden Prairie Campus
6:30 – 7:45 p.m.
Edina Campus
Free – No Registration
No class March 23

Moms Night Out

Mom's Group

January 20, March 9, April 20
and May 18 6:30 – 8 p.m.
Free – Registration Requested
Edina Campus

Moms Connect Early Years - PM

Moms Group

Alternating weeks January – May 4
6:30 – 8 p.m.
\$45/30 – Registration Required
Children's programming included
Eden Prairie Campus

Moms Connect School Years - PM

Moms Group

Alternating weeks January – May 11
6:30 – 8 p.m.
\$35/25 – Registration Required
Children's programming included
Eden Prairie Campus

Military

Prayer Group

Second Week

4:30 – 5:30 p.m.
Eden Prairie Campus

One Thousand Gifts

Women's Bible Study

Weekly April 13 – May 11
9:30 – 11:30 a.m.
\$20 – Registration Required
Eden Prairie Campus

Pizza and God Talk

Student Class

January 13, February 10,
March 16 and April 27
9 – 10 p.m.
Eden Prairie Davanni's
\$5 – No Registration

Senior High Impact

Student Class

Weekly January 6 – May 18
6:30 – 8:15 p.m.
Eden Prairie Campus
7:30 – 9 p.m.
Edina Campus
Free – No Registration
No Class March 23

Single Moms Connect

Moms Group

Weekly January – May 18
6:30 – 8 p.m.
Free – Registration Requested
Children's programming available
Eden Prairie Campus

Student Ministries

Prayer Group

Weekly – 9:30 – 10:30 a.m.
Eden Prairie Campus

Starting Point

Wooddale Class

Weekly January 13 - March 2
Or **Weekly** April 20 - Jun 8
6:30 - 8 p.m.
Free - Registration Requested
Edina Campus

Wednesday Morning

Men's Bible Study

Weekly January 7- May 25
6:30 a.m.
\$15 - Registration Required
Eden Prairie Campus

Wednesday Evening

Men's Bible Study

Weekly January 7- May 25
6:30 p.m.
\$15 - Registration Required
Eden Prairie Campus

Women's

Prayer Group

Weekly
12 - 1 p.m.
Eden Prairie Campus

Wooddale Avenue AA

Community Group

Weekly
8 - 9:30 p.m.
Edina Campus

Woods On Wednesday (W.O.W.)

Children's Class

Weekly January 7 - May 18
6:30 - 8 p.m.
Eden Prairie Campus
6:30 - 7:45 p.m.
Edina Campus
Free - Registration Requested



THURSDAY

1 Samuel Precept

Wooddale Bible Study

Weekly January 21 - March 17
6:45 - 9 p.m.
\$29 - Registration Required
Eden Prairie Campus

2 Samuel/1 Chronicles

Wooddale Bible Study

Weekly March 31 - May 26
6:45 - 9 p.m.
\$29 - Registration Required
Eden Prairie Campus

Alanon for Parents

Community Group

Weekly 7:30 - 9:30 p.m.
Edina Campus

DivorceCare

Wooddale Support Group

Weekly February 4 - May 5
6:45 - 8:30 p.m.
\$15 - Registration Required
Fee waived if you own the book
Eden Prairie Campus

Financial Peace University

Wooddale Class

Weekly January 21 - March 17
6:30 - 8:30 p.m.
\$97 - Registration Required
Eden Prairie Campus

Foxhall AA

Community Group

Weekly 7:30 - 9:30 p.m.
Eden Prairie Campus

Gamanon

Community Group

Weekly 7 - 8 p.m.
Eden Prairie Campus

Gamblers Anonymous

Community Group

Weekly 7 - 9 p.m.
Eden Prairie Campus

Moms in Prayer EP High School

Prayer Group

Second and Fourth Week
11:30 - 12:30 a.m.
Eden Prairie Campus

Moms Connect Early Years - AM

Moms Group

Alternating weeks
January - May 5
9:30 - 11:30 a.m.
\$60/40 - Registration Required
Children's programming included
Eden Prairie Campus

Moms Connect School Years - AM

Moms Group

Alternating weeks January - May 12
9:30 - 11:30 a.m.
\$35/25 - Registration Required
Children's programming included
Eden Prairie Campus

Moms of TEENS Connect

Moms Group

Second Thursday January 14 - May 5
9:15 - 11 a.m.
\$5 per speaker
Registration Requested
Eden Prairie Campus

Twelve Step Recovery

Community Group

Weekly 5:45 - 8 p.m.
Eden Prairie Campus

Uplifters

Wooddale Support Group

Weekly 6:45 - 9 p.m.
Eden Prairie Campus

Widows'

Support Group

Weekly April 7 - June 2
6:30 - 8:30 p.m.
\$15 - Registration Required

Wired Seminar

Wooddale Class

Weekly April 14 - April 21
6:30 - 8:30 p.m.
Free - Registration Requested
StrengthsFinder Assessment - \$15
Eden Prairie Campus

Quilters

Social Group

Second Thursday
8:30 - 5:30 p.m.
Fourth Thursday
8:30 - 5:30 p.m.
Free - Registration Requested
Eden Prairie Campus

FRIDAY

Grandparents at Prayer

Prayer Group

Weekly 10 a.m. - 12 p.m.
Eden Prairie Campus

IMMT Men

Prayer Group

Weekly 7:15 - 8 a.m.
Eden Prairie Campus

Quilters

Social Group

Second Friday
8:30 a.m. - 5:30 p.m.
Fourth Friday
8:30 a.m. - 5:30 p.m.
Free - Registration Requested
Eden Prairie Campus

SATURDAY

Saturday Morning

Men's Bible Study

Weekly January 9 - May 14
8:30 - 10 a.m.
\$20 - Registration Required
Eden Prairie Campus

Debtors Anonymous

Community Group

Weekly 10:30 a.m. - 12 p.m.
Eden Prairie Campus

Vision '22

Prayer Group

Last Week of Month
9 - 10 a.m.
Eden Prairie Campus

Knit Together

Social Group

First Saturday 2 - 4 p.m.
Free - No Registration
Eden Prairie Campus

Pre-Marital Seminar

Wooddale Class

January 9, 8:30 a.m. - 4:30 p.m.
Or May 14, 8:30 a.m. - 4:30 p.m.
\$25/person
Registration Required
Edina Campus

Getting to Know Wooddale

Wooddale Class

May 7, 8:30 - 11:30 a.m.
Free - Registration Requested
Eden Prairie Campus

Quilters

Social Group

Second Saturday
8:30 a.m. - 5:30 p.m.
Free - Registration Requested
Eden Prairie Campus

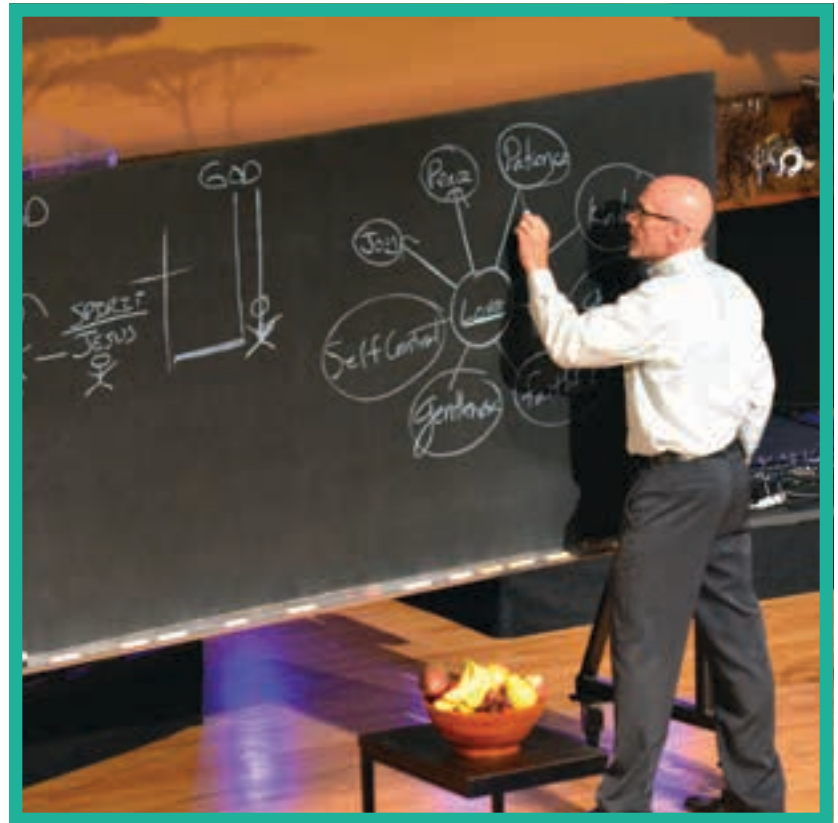

SUNDAY

Wired Seminar

Wooddale Class

Weekly January 31 - February 7
11 a.m. - 1 p.m.
Free - Registration Requested
StrengthsFinder Assessment - \$15
Eden Prairie Campus

Starting Point

Wooddale Class

Weekly February 14 - April 10
9:45 - 10:45 a.m.
Or **Weekly** April 3 - May 22
11 - 12 p.m.
Free - Registration Requested
Eden Prairie Campus

Saving Your Second Marriage - Re-marriage class

Wooddale Class

Weekly February 21 - April 24
9:45 - 10:45 a.m.
\$40 - Registration Required
Eden Prairie Campus

Journey Through Acts

Wooddale Class

Weekly
January 10 - May 22
no class on March 27
9:45 - 10:45 a.m.
\$25 - Registration Closed
Eden Prairie Campus

Narcissism & Co-Dependency

Wooddale Class

Weekly February 7 - February 28
8:30 - 9:30 a.m.
\$15 - Registration Required
Eden Prairie Campus

Pursuing Hope vs Fear

Wooddale Class

Weekly April 3 - April 24
8:30 - 9:30 a.m.
\$15 - Registration Required
Edina Campus

Family Toolbox

Wooddale Class

February 14, March 13
April 10 and May 1
11 a.m. - 12 p.m.
Free - No Registration
Eden Prairie Campus

Young Family LifeGroup

Wooddale Class

Weekly 9:45 - 10:45 a.m.
Free - No Registration
Eden Prairie Campus

Justice Connection

Prayer Group

Second Week of Month
11 a.m. - 12 p.m.
Eden Prairie Campus

Widows' Brunch

Social Group

Second Sundays
11 a.m. - 1 p.m.
Eden Prairie Campus

5th & 6th Grade Ignite

Student Class

Weekly
9:45 - 10:45 a.m.
Eden Prairie Campus
10:30 a.m.
Edina Campus
Free - No Registration

Junior High Supernatural Student Class

Weekly

9:45 - 10:45 a.m.
Eden Prairie Campus
10:30 a.m.
Edina Campus
Free - No Registration

Junior High LifeGroups Student Group

Dates vary by group

Eden Prairie Campus
Call 952.944.8360 to register
\$50 - Registration Required

Approved Unto God (AUG) Student Class

4 - 6 p.m. **Select Sundays**
Eden Prairie Campus
10:30 a.m. **Weekly**
Edina Campus

Class Dates available at Wooddale.org

Catalyst*

Student Class

3:30 - 5:30 p.m.
Eden Prairie Campus
Class Dates available at Wooddale.org

If you are interested in One-to-One Spiritual Mentoring, email spiritual.mentoring@wooddale.org

Big Groups

Wooddale Class

Weekly, 9:45 - 10:45 a.m.
Free - No Registration
Eden Prairie Campus

Parents of Teens is designed for families with 5th - 12th grade students to grow spiritually as they navigate parenting and family situations.

Single Life Connection is for single adults (40s and beyond) who want to grow and serve with others in a similar life stage.

New Horizons As adults move into their middle years of life (50s and 60s), New Horizons gives fresh perspective on life.

Transitions Is your nest empty? Join other parents in their 50s and 60s, who are caught in the "sandwich generation" and dive into topics about this life-stage.

Seasons It doesn't matter if you are married or single, Seasons is the class for you if you are in your 60s and 70s.

Second Half Senior Adults in their 60s and 70s explore the second half of life as they engage in a small group discussion-focused class with frequent special guests.

Bereans is a lecture style class for senior adults in their 70s and beyond who want to learn more about the Bible.

Events by Month

JANUARY EVENTS

1st Grade Bible Presentation

Children's Event

Sunday, January 10
9 and 10:30 a.m.
Edina Campus
Free – No Registration

1st Grade Bible Presentation

Children's Event

Sunday, January 10
11:15 a.m.
Eden Prairie Campus
Free – Registration Requested

Justice Connection: The Persecuted Church

Worldwide Event

January 10
11 a.m. – 12 p.m.
Eden Prairie Campus
Free – No Registration

Backyard Broomball

Young Adult Event

Sundays January 10, 17, 24 and 31
7:30 – 9:30 p.m.
Eden Prairie Campus
Free – No Registration

Family Worship Night

Edina Event

January 15
7 p.m.
Edina Campus
Free – No Registration

Junior High Snow Camp

Student Event

January 15 – 17
Depart 4 p.m. – Return 5 p.m.
Eden Prairie Campus Door 2
\$155 by 12/28, \$175 by 1/11
Registration Required

Breakfast at Tiffany's

Senior Adult Event

Saturday, January 16
10 a.m. – 12 p.m.
Eden Prairie Campus
\$15 – Registration Required

Sledding, Skating and Pizza

Family Event

Sunday, January 17
12 – 3 p.m.
Eden Prairie Campus
Registration Required

Family Experience

Children's Event

Friday, January 29
6 – 8 p.m.
Eden Prairie Campus
Free – No Registration

Taste of Global Youth Culture

Worldwide Event

Sunday, January 31
11 a.m. – 12 p.m.
Eden Prairie Campus
Free – Registration Required

Parent Child Dedication

Children's Event

Sunday, January 24
4:30 p.m.
Eden Prairie Campus
Sunday, January 31
9 and 10:30 a.m.
Edina Campus
Free – No Registration

Loring Park Campus Vision Meetings

EDEN PRAIRIE CAMPUS

Saturday, January 9
6:30 p.m.

Sunday, January 10
12 and 7:30 p.m.

Sunday, January 17
5 p.m.

Thursday, January 28
7 p.m.

FEBRUARY EVENTS

Love In[DEED]

Worldwide Event

Saturday, February 6
9 a.m. – 12 p.m.
All Campuses
Free – Registration Requested

Ash Wednesday Service

All-Church Event

Wednesday, February 10
7 – 8 p.m.
Eden Prairie Campus

5th & 6th Grade Snow Camp

Student Event

February 12 – 14
Depart 4:30 p.m. – Return 4 p.m.
Eden Prairie Campus Door 5
\$110 by 1/12, \$140 by 2/8
Registration Required

Widows' Valentine Dessert

Women's Event

Saturday, February 13
2 – 4 p.m.
Eden Prairie Campus
\$10 – Registration Required

Will You be My Valentine?

Senior Adult Event

Friday, February 19
11:30 a.m. – 2 p.m.
Eden Prairie Campus
\$15 – Registration Required

Senior High Snow Camp

Student Event

February 26 – 28
Depart 4 p.m. – Return 5 p.m.
Eden Prairie Campus Door 5
\$145 by 2/4, \$165 by 2/22
Registration Required

Spring Food Drive

Worldwide Event

February 27 – March 28
Eden Prairie and Edina Campuses
Free – No Registration

AUG/Senior Adult Pasta Dinner

Senior Adult/ Student Event

Sunday, February 28
4 – 6 p.m.
Eden Prairie Campus
\$10 – Registration Required
For Sr. Adults 55 years and older

Annual Meeting

All-Church Event

Monday, February 29
6:30 p.m.
Eden Prairie Campus

Loring Park Campus Vision Meetings

EDEN PRAIRIE CAMPUS

Tuesday, February 2
7 p.m.

Sunday, February 7
7:30 p.m.

EDINA CAMPUS

Sunday, February 7
11:45 a.m.

Events by Month

MARCH EVENTS

Family Movie & Game Night

Edina Event

Friday, March 4
6:30 – 9 p.m.
Edina Campus
Free – No Registration

Timberwolves Game

Family Event

Saturday, March 5
7 p.m.
Registration Required

309

Student Event

Wednesday, March 9
6 – 9 p.m.
Eden Prairie Campus
Free – No Registration

Game, Pizza and Movie Night

Children's Event

Friday, March 11
5:30 – 8 p.m.
Eden Prairie Campus
Register for pizza only

Women's Retreat: Divine Design

Women's Event

March 11 - 13
6 p.m. (11th) – 12 p.m. (13th)
Lake Beauty Bible Camp
\$130/150 – Registration Required

Junior High Slipper Formal

Student Event

Saturday, March 12
5 – 10:45 p.m.
Eden Prairie Campus Door 5
\$25 – Registration Required

Easter Schedule

Ash Wednesday Service

Wednesday, February 10 | 7 p.m.
Eden Prairie Campus

Palm Sunday Services

Sunday, March 20
Normal service times
All campuses

Maundy Thursday

Thursday, March 24 | 7 p.m.
Eden Prairie Campus

Easter Services

Saturday
March 26 | 5 p.m.
Eden Prairie Campus

Sunday

March 27
 7:30, 9, 10:30 a.m., and 12 p.m.
 Eden Prairie Campus
 9 and 10:30 a.m.
 Edina Campus

Children's Easter Services

Saturday
March 26 | 5 p.m.
Eden Prairie Campus

Sunday

March 27
 9, 10:30 a.m. and 12 p.m.
 Eden Prairie Campus
 9 and 10:30 a.m.
 Edina Campus

Family Easter Egg Hunt

between services
Edina Campus

Service times to be announced for
the Loring Park Campus @ Music Box
Theatre

Wooddale Choir Rehearsal Weekly 6:45-8 p.m. on Thursdays. Singers welcome!



APRIL EVENTS

Family Worship Night

Edina Event

Wednesday, April 13
6:30 – 8 p.m.
Edina Campus
Free – No Registration

Parade of Senior Homes

Senior Adult Event

Thursday, April 14
8:30 a.m. – 3:30 p.m.
Eden Prairie Campus
\$20 – Registration Required

Women's Health Expo

Women's Event

Saturday, April 16
9 a.m. – 12 p.m.
Eden Prairie Campus
\$18 – Registration Required
Children's Programming Available

One Big Party

Student Event

Wednesday, April 20
6:30 – 8:30 p.m.
Redeemer Bible Church
Free – No Registration

Love In[DEED]

Worldwide Event

Saturday, April 23
9 a.m. – 12 p.m.
All Campuses
Free – Registration Requested

We Are FOR Eden Prairie

Young Adult Event

Friday, April 29
6:30 – 10:30 p.m.
\$5 – Registration Requested

8th Grade Spring Blitz

Student Event

April 15 - 17
Depart 4 p.m. – Return 5 p.m.
Eden Prairie Campus Door 2
\$125 by 3/28, \$140 by 4/7
Registration Required

Sounds of Praise

Spring Performance

Children's Event

Friday, May 6
5 – 9 p.m.
Eden Prairie Campus

MAY EVENTS

Parent Child Dedication

Children's Event

Sunday, May 1
4:30 – 5:30 p.m.
Eden Prairie Campus
Free – Registration Requested

National Day of Prayer Breakfast

All Church Event

Thursday, May 5
7 – 8 a.m.
Eden Prairie Campus

5th & 6th Grade Color Games

Student Event

Saturday, May 14
2 – 4 p.m.
Eden Prairie Campus
\$10 – Registration Required

Justice Connection: Freedom from Slavery and Trafficking

Worldwide Event

Monday, May 15
11 a.m. – 12 p.m.
Eden Prairie Campus
Free – No Registration

Senior Baccalaureate Service

Student Event

Sunday, May 15
4 p.m. service, 5 p.m. dessert
Eden Prairie Campus
\$5 (graduate free)
Registration Requested

9th Grade Celebration

Student Event

Wednesday, May 18
6:30 – 8 p.m.
Eden Prairie Campus
Free – No Registration

AUG Graduation

Student Event

Friday, May 20
7 – 9 p.m.
Eden Prairie Campus
\$5/adults – Registration Required

6th Grade Celebration

Student Event

Wednesday, May 25
6:30 – 8 p.m.
Eden Prairie Campus
\$6 (6th graders free)
Registration Required

EDEN PRAIRIE CAMPUS SERVICES

Saturday

5:15 p.m. [CONTEMPORARY](#)

Sunday

8:30 a.m. [TRADITIONAL](#)

9:45 a.m. [CONTEMPORARY](#)

11 a.m. [CONTEMPORARY](#)

6 p.m. [THE GATHERING](#)

Online Viewing of all Services



EDINA CAMPUS SERVICES

Sunday

9 a.m. [CONTEMPORARY](#)

10:30 a.m. [CONTEMPORARY](#)

Coming Soon

**LORING PARK CAMPUS
@ MUSIC BOX THEATRE**

2016 PRAYER FOCUS

Pray that we will
Live to make Christ known

2016 VERSE

Galatians 2:20 (NIV)

²⁰ I have been crucified with Christ and I no longer live, but Christ lives in me. The life I now live in the body, I live by faith in the Son of God, who loved me and gave himself for me.

Philippians 1:21 (NIV)

²¹ For to me, to live is Christ and to die is gain.

WOODDALE CHURCH

Locations

Eden Prairie Campus

[6630 Shady Oak Road](#)
Eden Prairie, MN 55344

Edina Campus

[5532 Wooddale Avenue S](#)
Edina, MN 55424

Online Viewing

[wooddale.org/live](#)

Web

[wooddale.org](#)

Email

info@wooddale.org

Phone

952.944.6300



[WooddaleChurch](#)



[WooddaleEdina](#)

One church, multiple locations.

Eden Prairie Campus

